

Transmission Housing

Removal

NOTE:

- Replace all sealing washers, O-rings and oil seals.
- Always clean the magnet (26).

1. Remove the transmission housing following the numbered sequence.

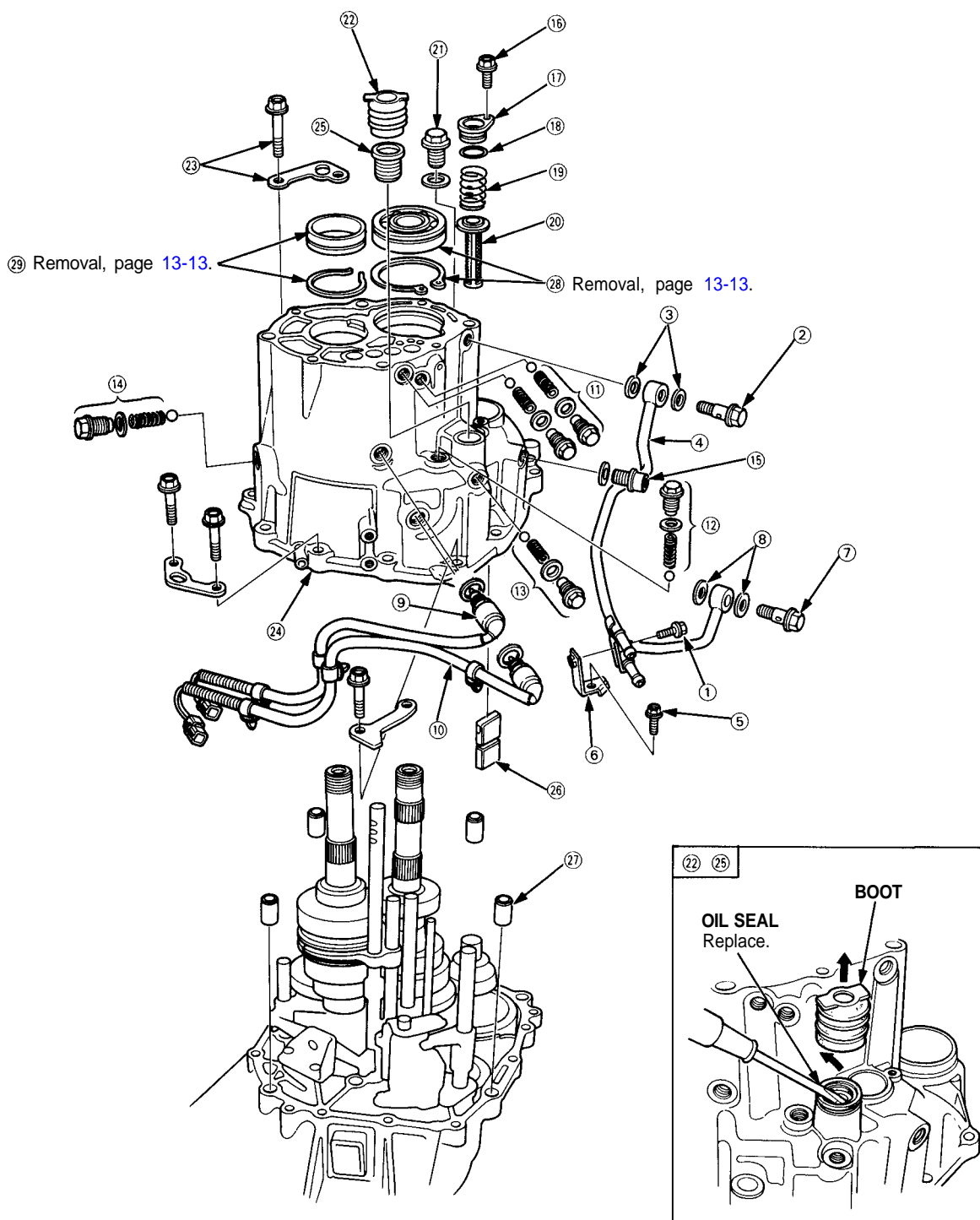



Bearing Removal

Mainshaft Side:

1. Remove the mainshaft ball bearing while expanding the snap ring, using the special tools.

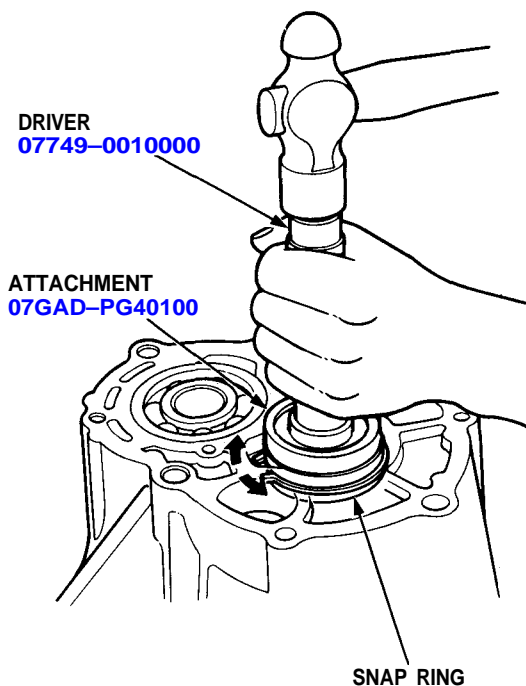

Countershaft Side:

1. Remove the countershaft bearing outer race while expanding the snap ring, using the special tools.

